

CHAMLIN & ASSOCIATES, INC. © 2023
 Drawing Name: K:\Jobs\24-118 Coal City Library (Blueprints)\Drawings\ED1.0_FLOOR PLAN - ELEC DEMO.dwg
 Last Modified: Friday, September 13, 2024 2:51:48 PM
 Plotted On: Friday, September 13, 2024 2:55:45 PM
 by Keaton Price

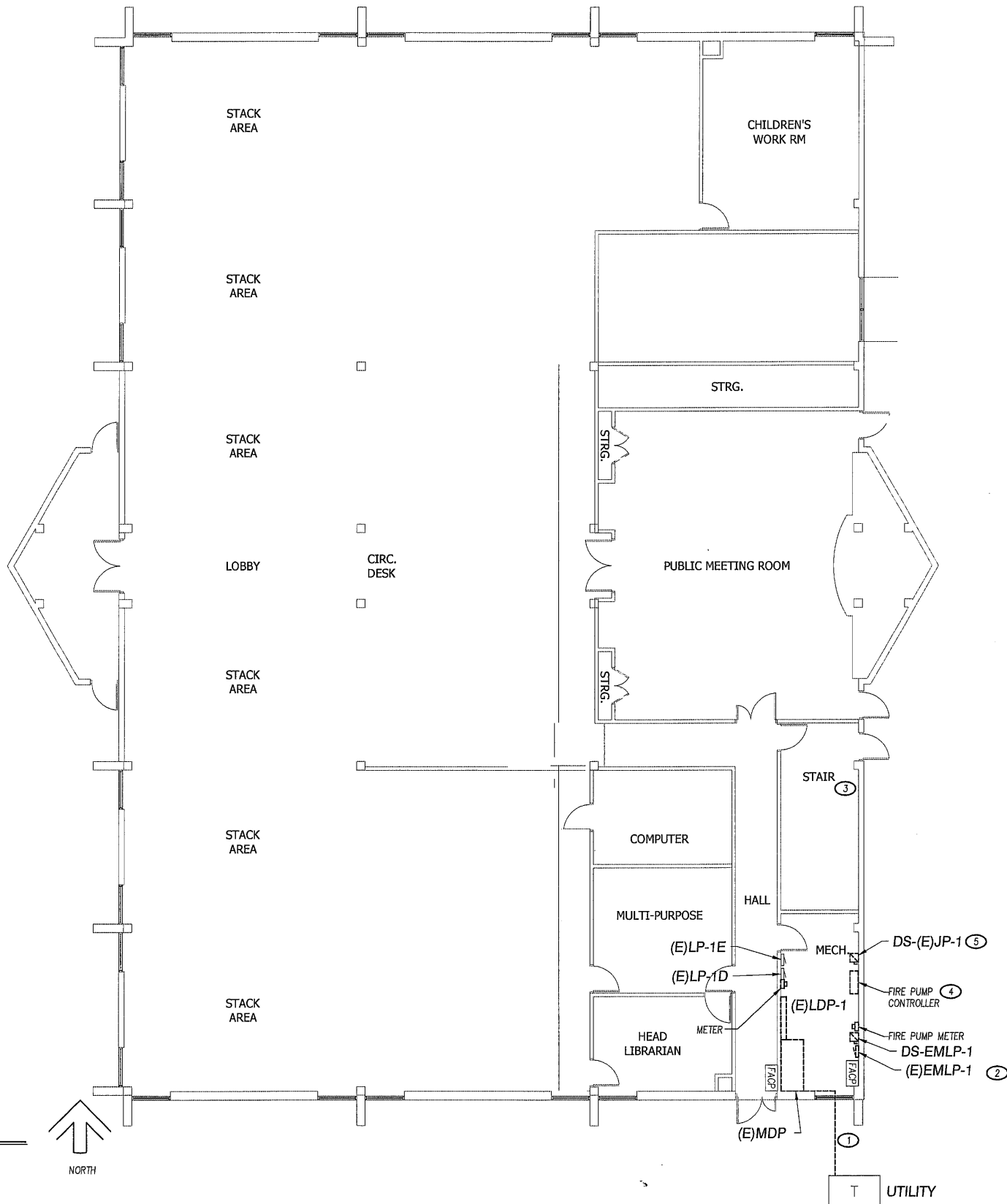

1 FIRST FLOOR PLAN - ELECTRICAL DEMO
 SCALE: 1/8" = 1'-0"



KEYED ELECTRICAL NOTES (THIS SHEET):

- ① DEMOLISH EXISTING SERVICE CONDUIT AND CONDUCTORS.
- ② PANEL (E)EMLP-1 TO BE RELOCATED TO NEW LOCATION. SEE SHEET E1.0 FOR NEW LOCATION. EXTEND AND MODIFY CONDUIT AND WIRING AS NECESSARY.
- ③ EXISTING CONDUIT IN THIS SPACE TO BE ADJUSTED FOR LOCATION OF NEW ATS-1. EXTEND AND MODIFY CONDUIT AND WIRING AS NECESSARY.
- ④ DEMOLISH EXISTING FIRE PUMP CONTROLLER. REUSE EXISTING FIRE ALARM CONNECTIONS AT PANEL FOR NEW FIRE PUMP CONTROLLER.
- ⑤ JOCKEY PUMP (JP-1) MOTOR STARTER TO BE RELOCATED TO NEW LOCATION.



BRUNER, COOPER & ZUCK, INC.
 835 Golden Valley Drive
 Bettendorf, IA 52722
 563.355.1856
 2024121-3

DRAWN BY:	REVISIONS		
	LEVEL	BY	DATE
CHECKED BY:			
DATE:			

PERU MORRIS
 OTTAWA MENDOTA
 ILLINOIS

VILLAGE OF COAL CITY
LIBRARY ELECTRICAL WORK
 2024

FLOOR PLAN - ELECTRICAL DEMOLITION

KEITH
 Engineering
 Design

CURRENT AS OF: 09/16/2024	
SCALE: AS-NOTED	SHEET 1
FILE NO.: 2473.00	OF 3

CHAMLIN & ASSOCIATES, INC. © 2023
 Drawing Name: K:\Jobs\24-118 Coal City Library (Bluestone)\Drawings\E1.0_FLOOR PLAN - ELEC POWER.dwg
 Last Modified: Friday, September 13, 2024 2:51:26 PM
 Plotted On: Friday, September 13, 2024 2:56:05 PM
 by Keaton Price

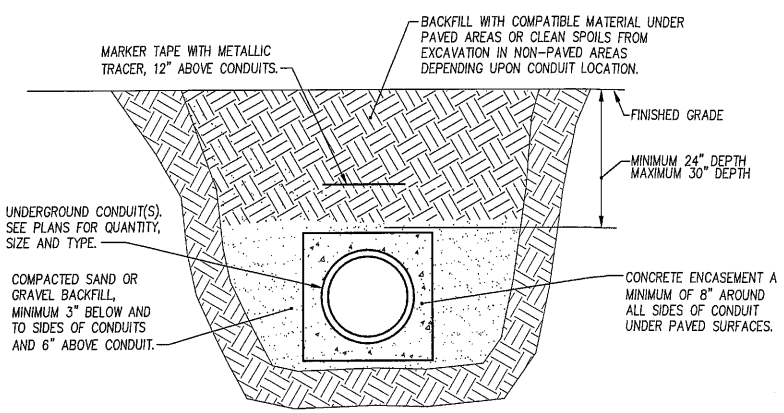
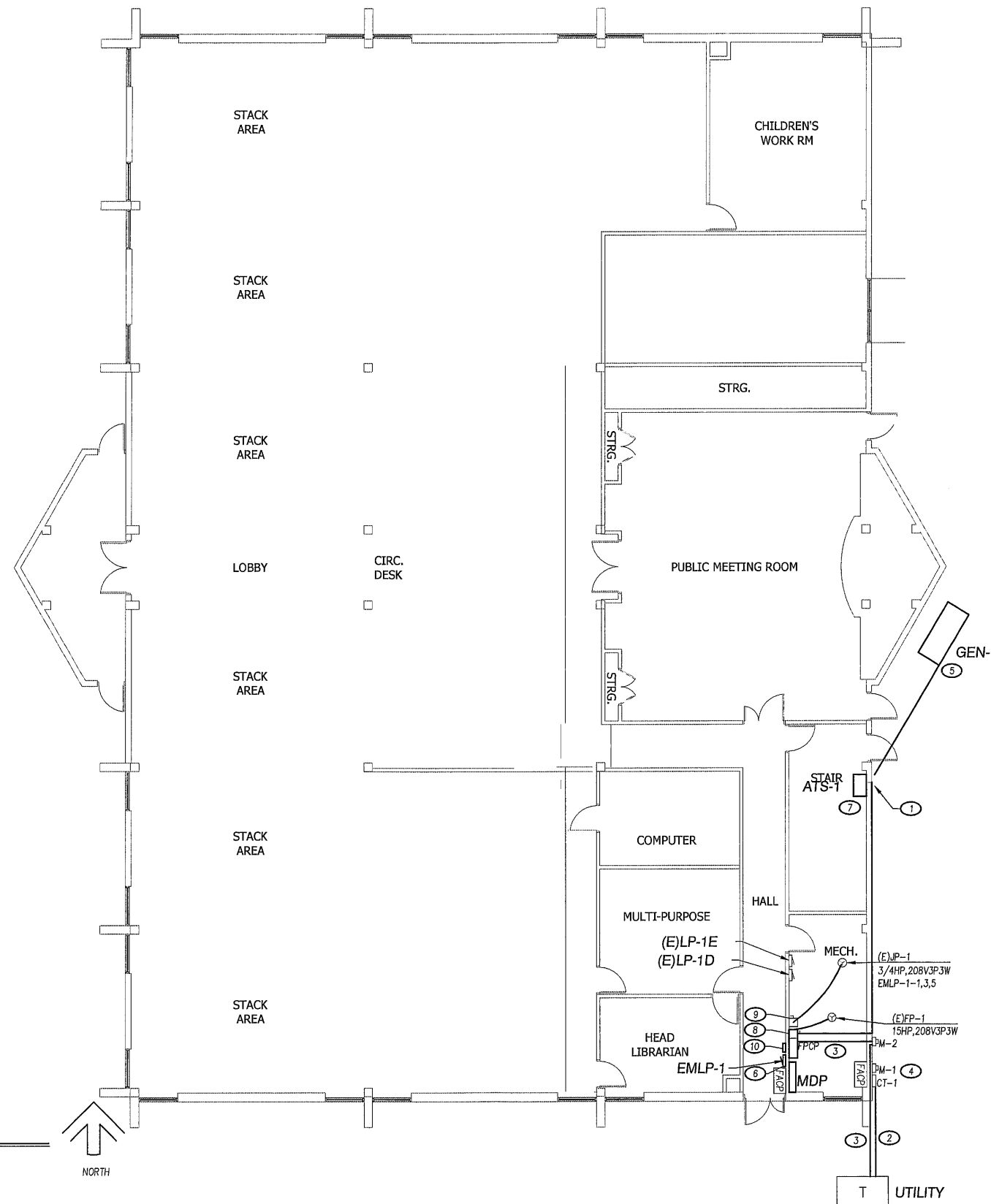

1 UNDERGROUND CONDUIT DETAIL
 SCALE: NONE

- NOTES:**
- INSTALL 200 lb TENSILE STRENGTH PULL ROPE IN ALL EMPTY CONDUITS UNLESS SPECIFICALLY NOTED OTHERWISE.
 - TRENCHING AND BACKFILL SHALL CONFORM TO ALL SPECIFICATION REQUIREMENTS.

KEYED ELECTRICAL NOTES (THIS SHEET):

- FURNISH AND INSTALL A NEMA 3R RATED PANEL. PANEL SHALL BE 120/208V, 3-PHASE, 4-WIRE AND SHALL BE USED TO SERVE AUTOMATIC TRANSFER SWITCH, AND FIRE PUMP CONTROLLER ONLY.
- ROUTE 4 SETS EACH OF 3#350MCM IN 3" SCHEDULE 80 PVC FROM TRANSFORMER TO CT CABINET.
- ROUTE #4AWG & #8G IN 1" SCHEDULE 80 PVC FROM TRANSFORMER TO METER/CT CABINET. POWER WIRING SHALL COMPLY WITH NEC 695.6(A)(1). WHERE ROUTED THROUGH A BUILDING, THE CABLE OR RACEWAY IS PART OF A LISTED FIRE-RESISTIVE CABLE SYSTEM.
- FURNISH AND INSTALL UTILITY APPROVED METER CABINET WITH 1-1/4" RMC/IMC TO CT CABINET.
- FURNISH AND INSTALL NATURAL GAS EMERGENCY GENERATOR. SEE SHEET E2.0 FOR ADDITIONAL INFORMATION. E.C. IS RESPONSIBLE FOR CONCRETE GENERATOR PAD. PROVIDE PAD WITH DIMENSIONS THAT EXCEED GENERATOR HOUSING BY A MINIMUM OF 6". PAD SHALL EXTEND ABOVE FINAL GRADE BY A MINIMUM OF 4". A 4"CA6 SUB BASE SHALL BE LAID AND LEVELED BEFORE POURING. FINAL LOCATION TO BE APPROVED BY OWNER. EXTEND CONDUIT UNDERGROUND TO BUILDING EXTERIOR. CONDUIT SHALL BE SCHEDULE 80 PVC, SEE DETAIL #1 FOR ADDITIONAL DETAILS.
- RELOCATED EXISTING PANEL. EXTEND AND MODIFY CONDUIT AND WIRING AS NECESSARY.
- ROUTE CONDUIT FROM ATS-1 ALONG THE WALL AND THROUGH THE IT CLOSET INTO THE MECHANICAL SPACE.
- CONNECT EXISTING FIRE ALARM CONNECTIONS TO NEW FIRE PUMP CONTROLLER.
- RELOCATED MOTOR STARTER FOR (E)JP-1.
- FURNISH AND INSTALL REMOTE ANNUNCIATOR AND STOP SWITCH FOR GENERATOR.



BRUNER, COOPER & ZUCK, INC.
 835 Golden Valley Drive
 Bettendorf, IA 52722
 563.355.1856
 2024121-3

1 FIRST FLOOR PLAN - ELECTRICAL WORK
 SCALE: 1/8" = 1'-0"

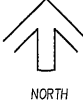

DRAWN BY:	REVISIONS			
	LEVEL	BY	DATE	DESCRIPTION
CHECKED BY:				
DATE:				

CA
 Chamlin & Associates
 PERU MORRIS
 OTTAWA MENDOTA
 ILLINOIS

**VILLAGE OF COAL CITY
 LIBRARY ELECTRICAL WORK
 2024**

FLOOR PLAN - ELECTRICAL WORK

KEITH
 ENGINEERING
 Energy

CURRENT AS OF: 09/16/2024	
SCALE: AS-NOTED	SHEET 2
FILE NO.: 2473.00	OF 3

